

# User's Manual

## MOA0.6-AD



# Table of Content

- ☞ Ozone Introduction .....1
- ☞ Features and Specification .....1
- ☞ Structure and Accessories ..... 2
- ☞ Installation and Usage ..... 3
- ☞ Application .....4
- ☞ Safety and Cautions ..... 5
- ☞ FAQ .....6
- ☞ Maintenance Service .....6
- ☞ Warranty card .....6

## I、 Ozone Introduction

Ozone, O<sub>3</sub>, is a molecule that consists of three negatively charged oxygen atoms and is a normal constituent of the earth's atmosphere. Ozone is produced deliberately for a variety of industrial purposes and medical therapy purposes, and is also produced naturally from oxygen whenever ultra-violet radiation or electrical discharges occur, e.g. at high altitudes or by the action of lightning. Ozone itself is a distinctly blue coloured gas (bp – 111.9°C) and is about one and a half times heavier than air (density 2.144g/l). Ozone is used as “ozone air”, a colourless gas produced when ozone is generated from part of the oxygen in air. Ozone cannot be stored or transported in vessels because it falls back into its original form (oxygen) after a while.

Medical ozone has highly pronounced bactericidal, fungicidal and virostatic properties, and is thus widely used in disinfecting infected wounds, as well as in bacterially and virally produced diseases.

## II、 Features and Specification

### 1. Feature

The device is an ozone therapy machine that designed for multi-treatments with medical pure ozone gas. It uses Double Walls of Pure Quartz Electrode to make pure oxygen/ozone mixed gas in high accuracy of ozone concentrations.

The Double Walls of Pure Quartz Electrode is a patented design that offers Ultra-pure Ozone and constant stable ozone concentration. It is a latest technology that makes sure NO ANY metal, plastic, ceramic, rubber, glues, etc., be at the ozone generating area. Pure Quartz is the ONLY material at the ozone generating area. The strain point of this pure quartz is 1110 °C, and its soften point is 1670 °C. It is 100% ozone resistant, an ideal material for high frequency high voltage electrode. It makes Ultra-pure ozone without any contaminants.

It can deliver pure ozone from low to high concentrations (2~ 95 ug/mL) for different therapy applications. It has a power (VC) meter with knob for adjusting the ozone concentrations. Also, it has been built-in two powerful ozone destructors which can remove extra ozone gas, and a powerful vacuum pump with 0.07 Mpa pressure.

### 2. Specification

Model No.	MOA0.6-AD
Ozone Concentrations	2~95ug/mL ( 1 ug/mL = 1 gamma = 1 mg/L ) adjustable
Air Source	Pure oxygen only; 1/32~1.5 LPM
Ozone Module Technology	Double Walls of Pure Quartz Electrode Technology
Cooling System	4000 RPM , turbo brushless cooling fan
V/C Meter with Knob	~12 VDC, 0~0.65A
Ozone Destructor	Powerful catalyst*2 pieces
Life	> 10,000 hours
Input Voltage	12V DC (100-240V AC to 12V DC adaptor)
Rated Power	< 18 W
Operating Temperature	~ 25°C
Storage Temperature	-0°C ~ 50°C
Product Size(L x W x H)	325*220*108 mm

Package Box Size(L x W x H)	340 *250*160 mm
Weight	3.3 kg

### 3. Ozone Concentration Chart:

O2 flow (LPM)	Current in A(ampere) & Ozone Concentration in ug/mL (1 ug/mL = 1mg/L = 1 gamma)														
	Current														
1 1/2 (1.5)	Current	0.36	0.46	0.57											
	O3 Conc.	2	3	4											
1	Current	0.41	0.47	0.54	0.60										
	O3 Conc.	4	5	6	7										
3/4 (0.75)	Current	0.34	0.39	0.45	0.49	0.55	0.60								
	O3 Conc.	4	5	6	7	8	9								
1/2 (0.5)	Current	0.33	0.37	0.40	0.43	0.47	0.51	0.55	0.59						
	O3 Conc.	6	7	8	9	10	11	12	13						
1/4 (0.25)	Current	0.27	0.29	0.33	0.36	0.37	0.39	0.41	0.42	0.44	0.46	0.48	0.5	0.54	0.57
	O3 Conc.	9	11	13	14	15	16	17	18	19	20	21	22	24	25
1/8 (0.13)	Current	0.34	0.38	0.44	0.50	0.56	0.62								
	O3 Conc.	25	30	35	40	45	50								
1/16 (0.06)	Current	0.32	0.35	0.38	0.42	0.46	0.52	0.6							
	O3 Conc.	40	45	50	55	60	65	70							
1/32 (0.03)	Current	0.33	0.38	0.48	0.56	0.62									
	O3 Conc.	65	75	85	90	95									

\* Operation Notices:

1. O3 concentration will vary from oxygen purity. This ozone concentration setting table is based on pure oxygen.
2. This setting table is based on 25°C working environment

### III、 Structure & Accessories

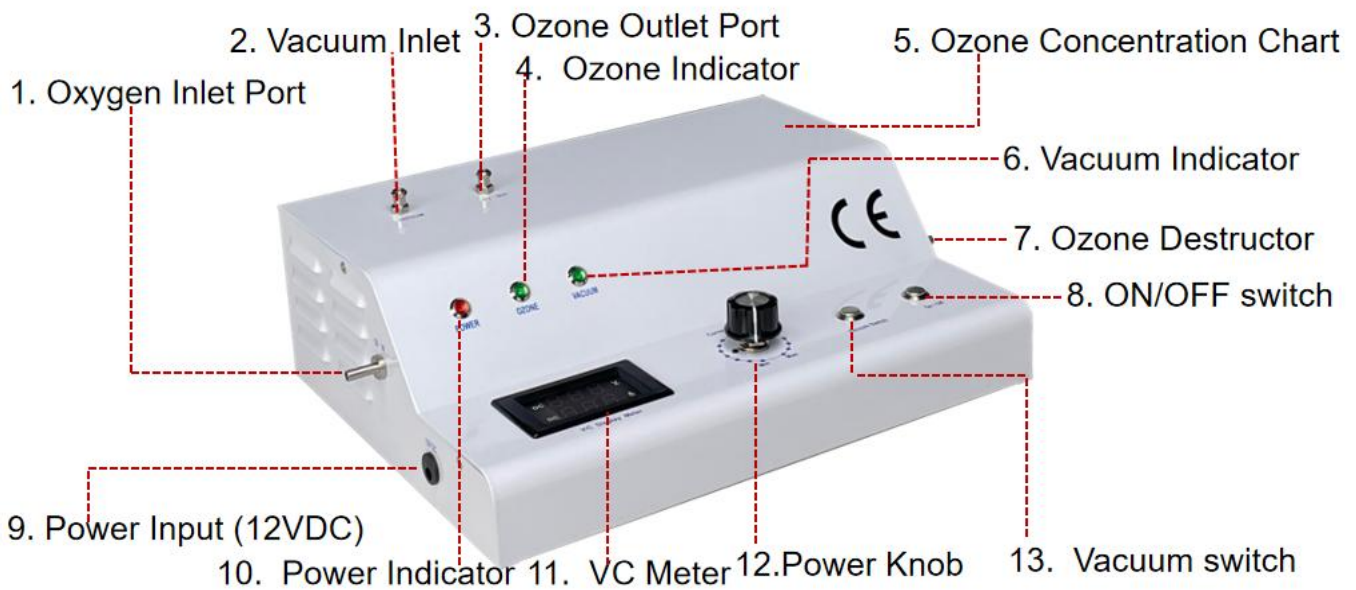

### Accessories:



1pc \* Power Adaptor / 1pc \* 3 way connector / 3pcs \* male luer connector / 1 pc \* silicon tubing / 1pc \*oxygen filter



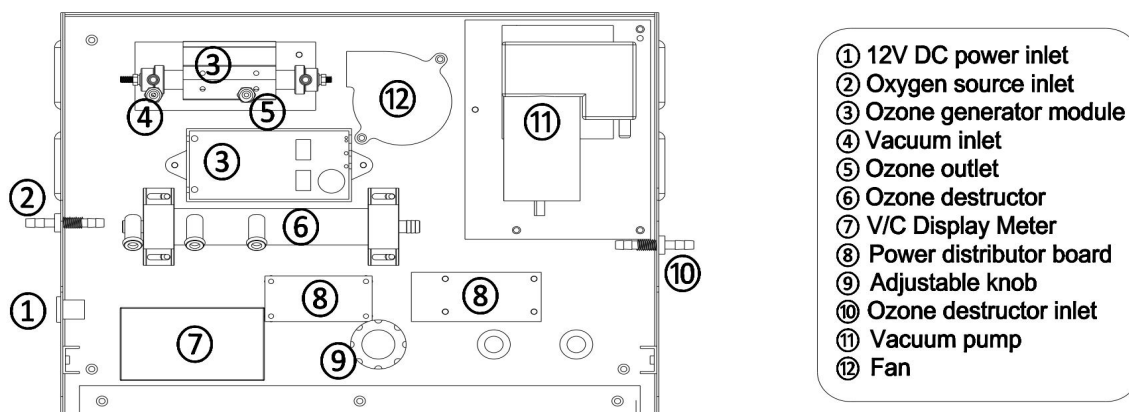

#### IV、 Installation and Usage

1. Take out the appliance and accessories from the package, put it on a flat ground in which space you are going to run the appliance.
2. Connect the oxygen source to the Oxygen Input connector (O2 IN) . Make sure the oxygen filter is used to protect the appliance for long life usage. Pure oxygen source should be used ONLY to get accurate ozone concentrations.
3. Connect the 3 way connector to the Ozone Outlet (O3 OUT)
4. Cut a short piece of silicon tubing, add one male luer lock connector to one end, then connect the side outlet of 3 way connector to the Ozone Destructor (O3 Destructor)
5. Adjust the 3 way connector, make sure the gas flow is from the Ozone Outlet (O3 OUT) to the Ozone Destructor inlet (O3 Destructor) before switch on the appliance.
6. Connect the direct outlet of 3 way connector to the syringe or ozone bags, etc.
7. Plug in the 12V DC power adaptor to the Mains and the appliance. The “POWER” indication light is red when the power is connected successfully.
8. Press the ON/OFF switch. The ‘OZONE’ indicator will be ON when ozone starts working.
9. Open the oxygen source. Check the ozone concentration chart. Turn the Adjusting Current Knob to get the ozone concentration you need.
10. Adjust the 3 way connector, make the gas flow to the syringe or ozone bags, etc.
11. After collecting the ozone, adjust the 3 way connector, make the gas flow back to the Ozone Destructor (O3 Destructor) again.
12. Press the ON/OFF Switch and turn the appliance off.
13. Close the oxygen source, and unplug the appliance.

**\*NOTE:**

1. For making ozonated water, it does not need the 3 way connector. Just connect the O3 Outlet Port to the ozone glass cup inlet directly, and connect the ozone glass cup outlet to the O3 destructor.
2. The Vacuum pump is controlled by its own button ‘Vacuum Switch’. Just press this switch to use the vacuum functions when in need



V、 Applications



Ozone Joint Injection



Ozone Major/minor Autohemotherapy



Ozone for Rectal Insufflation



Ozone for Vaginal Treatment



Ozone Drinking Water



Ozone for Leaky Gut Treatment



Ozone for making Ozone Oil



Ozone for Wound Healing

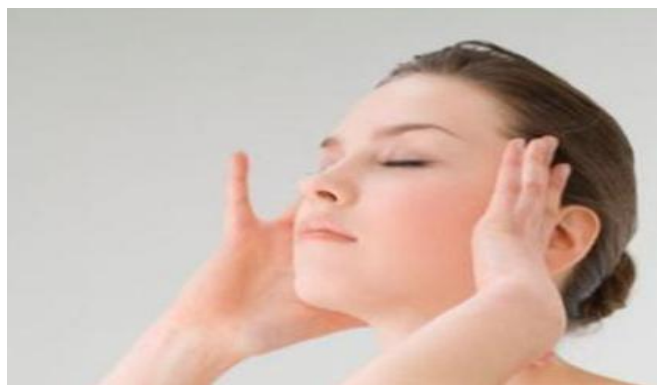

Ozone for Ear Insufflation



Ozone for Nasal & Sinus Insufflation



Ozone for dental



Ozone Sauna



Ozone for Lyme disease treatment



Ozone for Cancer treatment

## VI、 Safety and Cautions

1. Make sure that all accessories are attached in the box and the appliance is in good condition when it is received. Always keep the appliance vertical on the flat ground.
2. Do not store the appliance in a humid place.
3. Only feed in pure oxygen source to get accurate ozone concentration outputs
4. Operate the appliance in a precondition within  $\sim 25^{\circ}\text{C}$  &  $0 \sim 70\% \text{ RH}$
5. Do dis-connect the adapter before opening the product or any maintenance.
6. It is not recommended to switch on & off frequently on this appliance. To avoid any defective, please re-switch on the appliance at least 2mins after switching off.
7. Do not block the ventilated fan and outlet of the appliance all the time.
8. Turn off this appliance and unplug the adapter immediately when there is ozone leakage inside the housing. A space with ventilation is preferable to stay when this happens.
9. Do not operate the appliance in flammable or explosive places.
10. Do not allow water go into the appliance.
11. Pack the appliance into a box if it is not going to use for a long while

**VII、 FAQ**

Queries	Answers
Power indication light doesn't work after plugging the adapter to the mains power socket	<ul style="list-style-type: none"> <li>a. if the adapter is well connected to the appliance or not</li> <li>b. if the indication light of the adapter on or off</li> <li>c. if the adapter is in good condition or not</li> <li>d. unplug the adapter and open the appliance, check if the wire of power connector is in good condition or not</li> </ul>
No ozone comes out when the appliance is on, and the power and ozone indication light is on as well	<ul style="list-style-type: none"> <li>a. if the oxygen source has been connected and be offered to make ozone</li> <li>b. the fan is working or not</li> <li>c. unplug the adapter and open the appliance, check if the connection inside is in good condition or not</li> <li>d. if the quartz tube of the ozone module is broken or not</li> <li>e. change the ozone generator module or ask for help from whom is responsible for.</li> </ul>
The ozone smell is very strong around the appliance	<ul style="list-style-type: none"> <li>a. If the ozone outlet connectors are connected well</li> <li>b. If the ozone destructor be connected properly</li> <li>c. If the ozone destructor need replacements</li> </ul>
Vacuum doesn't work	<ul style="list-style-type: none"> <li>a. If the 'Vacuum Switch' has been turned ON</li> </ul>
Who is allowed to operate the appliance	People who are trained or with relative knowledge of ozone appliance is allowed to operate or repair it

**VIII、 Maintenance Service**

1. This Ozone Therapy Machine is warranted to be free from all defects in material in normal ozone therapy use for a period of (1) year from date of purchase.
2. The warranty is guaranteed only to the original purchaser and members of his or her immediate household. The warranty is subject to the following provisions. Any damages or malfunctions caused by negligence, abuse, or not operate in accordance with the User's Manual are not covered by this warranty. Also, any defects or damages caused by unauthorized service or the use of other than Genuine parts are not covered.
3. YOUMO AQUAPURE will, at its option, repair or replace a defective ozone generator or part(s) for the unit that is covered by this warranty. As a matter of warranty policy, YOUMO AQUAPURE will not refund the customer's purchasing price. Please recorder the following Warranty Card when you purchase the unit from our company or the distributor.
4. To obtain warranty service you must return the defective ozone generator or its parts along with proof of purchasing to our company or any Authorized Warranty Station. All transportation charges on parts, or units, submitted under this Warranty shall be borne by purchaser.

**IX、 Warranty card**

<b>Customer Name</b>		<b>Model No.</b>	
<b>Purchase Date</b>		<b>Serial No.</b>	
<b>Customer Address</b>			
<b>Customer Phone</b>			